

REVISIONS		
REV. NO.	DESCRIPTION	DATE

**INDEX OF SHEETS**

- 31. GENERAL PLAN & ELEVATION BRIDGE "A"
- 32. GENERAL PLAN & ELEVATION BRIDGE "B"
- 33. REMOVAL DETAILS OF BRIDGE "A"
- 34. REMOVAL DETAILS OF BRIDGE "B"
- 35. SUBSTRUCTURE STAKING DIAGRAM
- 36.-37. FOUNDATION REPORT
- 38.-39. DETAILS OF ABUTMENTS BRIDGE "A"
- 40.-41. DETAILS OF ABUTMENTS BRIDGE "B"
- 33. DETAILS OF WINGS BRIDGE "A" & "B"
- 43.-44. DETAILS OF PIERS BRIDGE "A"
- 45.-46. DETAILS OF PIERS BRIDGE "B"
- 47. DETAILS OF PIER FOUNDATIONS
- 48.-51. DETAILS OF SUPERSTRUCTURE
- 52.-53. DETAILS OF STRUCTURAL STEEL
- 54.-55. DETAILS OF APPROACH SLABS
- 56. DETAILS OF SLOPE WALLS

**DESIGN DATA:**

CONCRETE CLASS A  $f'_c$  3000 PSI  
 (SUBSTRUCTURE)  
 CONCRETE CLASS AA  $f'_c$  4000 PSI  
 (SUPERSTRUCTURE)  
 STRUCTURAL STEEL ASSHTO M270 (GRADE 50W)  
 (ASTM A709)  
 BOLTS AASHTO M164 (ASTM A325)  
 CONCRETE REINFORCEMENT AASHTO M31 (GRADE 60) (ASTM A775)

**LIVE LOAD:**

AASHTO HL-93; OR OKLAHOMA OVERLOAD TRUCK;  
 ADTT 4000

LFD OPERATING RATING: HS 104.0 (HL-93)

**ABUTMENTS (HP 10x42):**

FACTORED PILE REACTION (TONS/PILE)				
ABUT 1	PIER 1	PIER 2	ABUT 2	
29.7	44.2	44.2	29.7	

**BRIDGE STANDARDS**

- FSHP-42-2-00E
- EJ-SK-04E
- EJ-DTL-02E
- HP1-2-01E
- B40-STL-BM-BRACING-00E
- B40-C-DIA-RB-1-01E
- B40-C-DIA-RB-2-02E
- B40-C-BRG-RB-01E

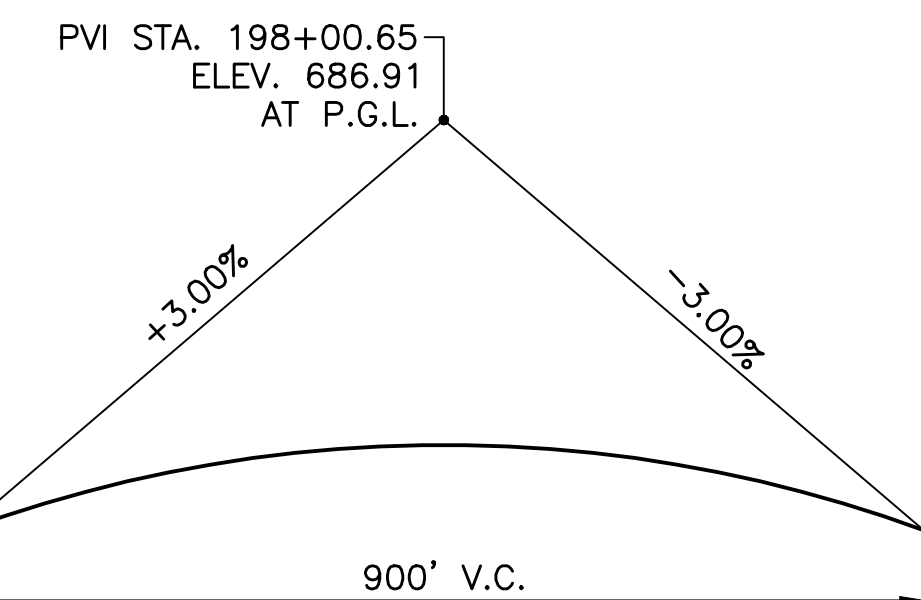

**VERTICAL CURVE DATE**

DESIGN	MW	11/16	OKLAHOMA DEPARTMENT OF TRANSPORTATION <b>GENERAL PLAN &amp; ELEVATION          BRIDGE "A"</b> STATE JOB NO. 28884(04) SHEET NO. 31
DRAWN	SDK	11/16	
CHECKED	HRA	11/16	
APPROVED			
WALTER P MOORE			

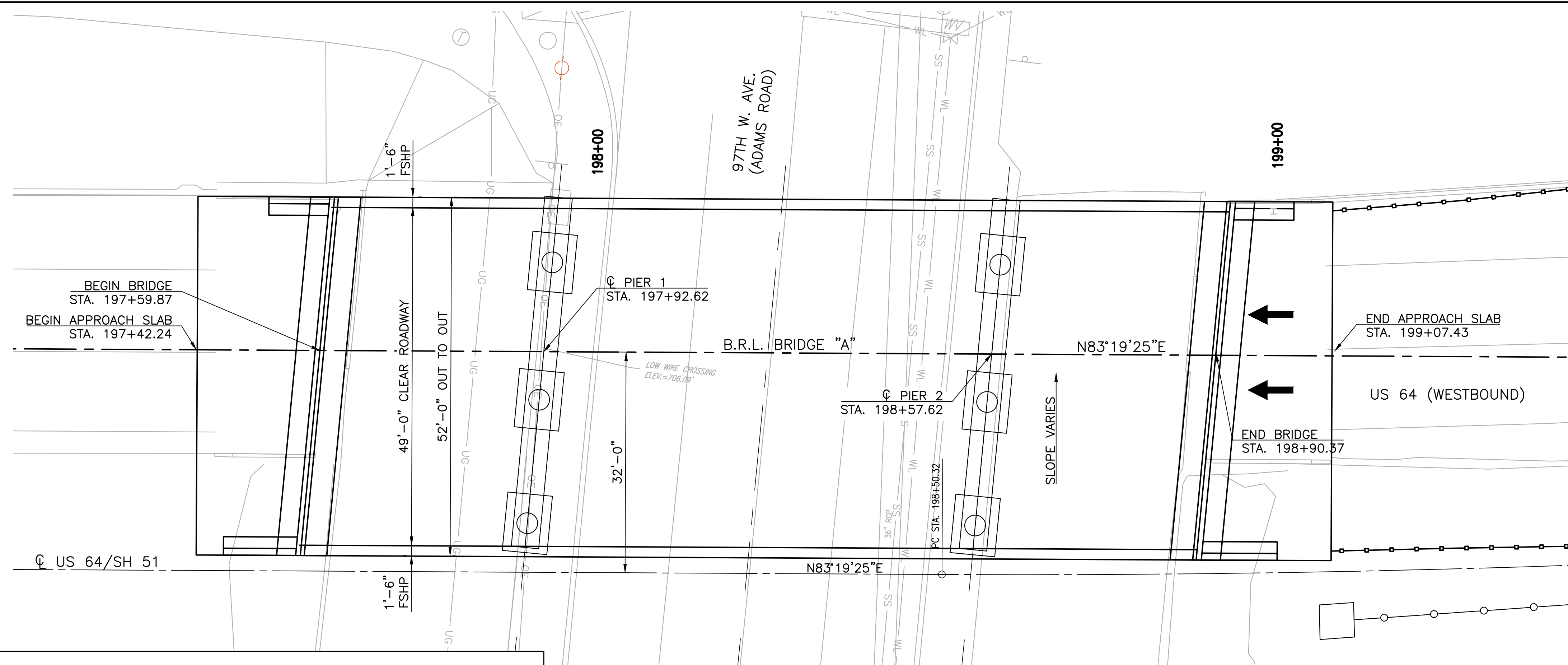

**PLAN**

NOTE:  
 ALL PILING SHALL BE DRIVEN THROUGH THE COMPACTED FILL TO A POINT OF BEARING ON A SOLID FOUNDATION MATERIAL AT THE APPROXIMATE ELEVATION SHOWN ON THE PLANS. IF THE REQUIRED AXIAL LOAD RESISTANCE IS NOT OBTAINED AT THIS ELEVATION, DRIVING SHALL CONTINUE UNTIL THE REQUIRED AXIAL LOAD RESISTANCE IS OBTAINED. THE LENGTH OF THE STEEL PILING SHOWN ON THE PLANS IS FOR ESTIMATING PURPOSES ONLY.

NOTE:  
 ELEVATIONS SHOWN ARE FROM THE PROFILE GRADE LINE (P.G.L.) WHICH IS OFFSET 20' LEFT OF C.R.L. FOR BRIDGE "A" AND 20' RIGHT OF C.R.L. FOR BRIDGE "B".

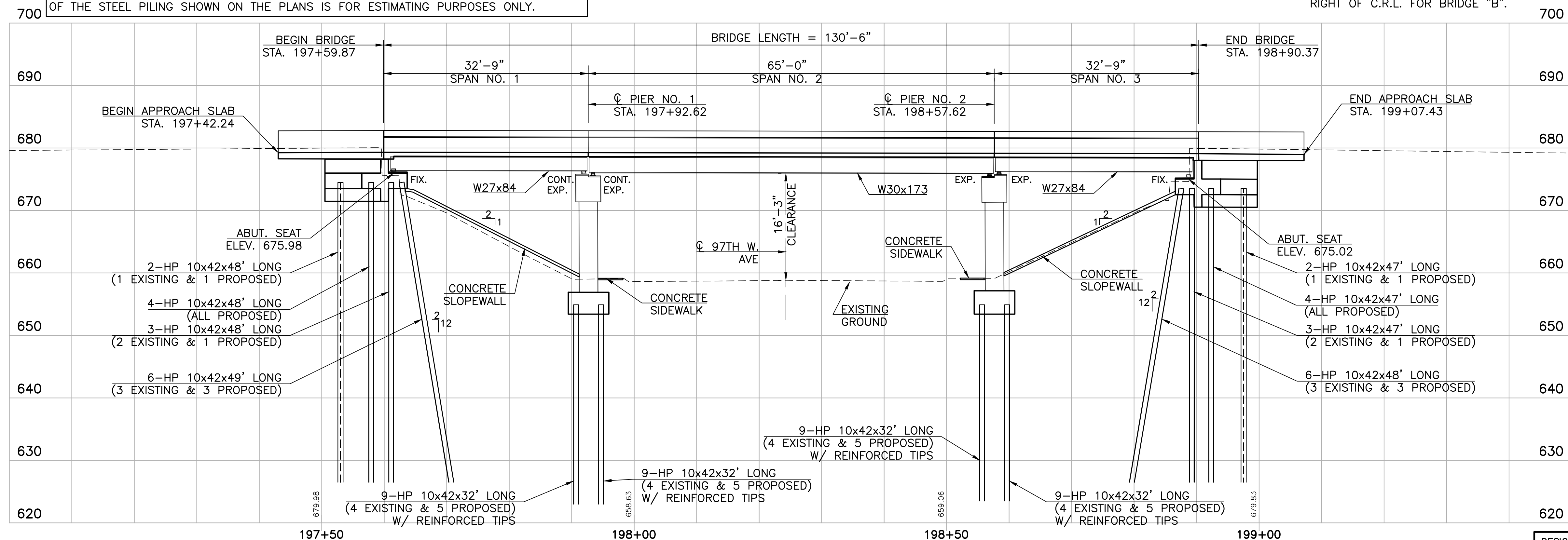

**ELEVATION**

STA. 197+38.79  
 SUPERELEVATION  
 (CROSS-SLOPE) = 1.56%

STA. 199+16.43  
 SUPERELEVATION  
 (CROSS-SLOPE) = 4.80%

V:\MPS\2012\2000-07\_0000\_EE-144\_US-64\_Book\_3\CD\05\Sta 31-32\_M12-10001-07.dwg Job: 12, 2017 - 4:22pm wpmk